

Speed Queen®

On-Premises

Stack Dry Tumbler

30 lb (13.6 kg) Stack Drying Tumbler

45 lb (20.4 kg) Stack Drying Tumbler



A Passion to Lead

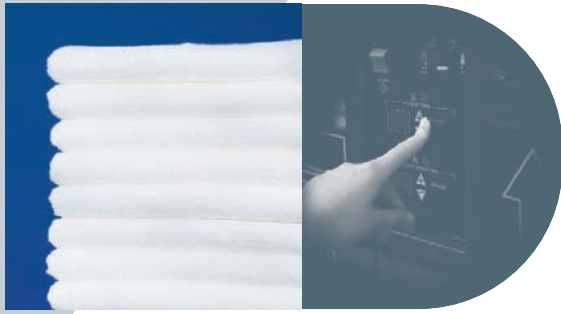

Speed Queen On-Premises Stack Drying Tumblers

The on-premises laundry business is changing. Managers today must be flexible in adapting quickly to changes to linen processing formulas, while keeping operating costs within budget. Features that a few years ago were considered luxuries are now essential components to doing business.

Speed Queen is dedicated to giving managers the power to respond instantly to changes in order to produce superior wash quality. Programming ease and user-friendly operation ensure our technology makes your life easier, not more complicated.

Dual Digital Control

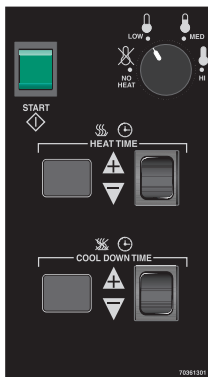

Dual Digital Control models enable operators to set drying time (0-60 minutes), cool down time (1-15 minutes) and temperature (High, Medium, Low, No Heat). Features include one-touch cycle repeat, automatic extended tumble and a large digital time countdown display.



Classic Durability

For more than 100 years, the Speed Queen name has been synonymous with quality construction. That reputation continues today. All our commercial tumblers are built on heavy-duty frames and utilize extremely durable internal components. Our commitment to quality ensures your laundry receives years of service from Speed Queen products.



Efficiency = Productivity

The faster and more efficient your dryers are, the more productive your operation will be. Speed Queen's stack commercial dryers, offered in 30 and 45 lb models, feature an axial airflow process. This pattern ensures heated air comes in contact with the load at the optimum time in the tumble process. Bottom line? It's the fastest, most efficient drying process to save your operation in utility costs.

An Easy Open-and-Shut Case

Extra-large stainless steel doors and heavy-duty hinges ensure they can stand up to the repeated use of high-volume on-premises laundries.

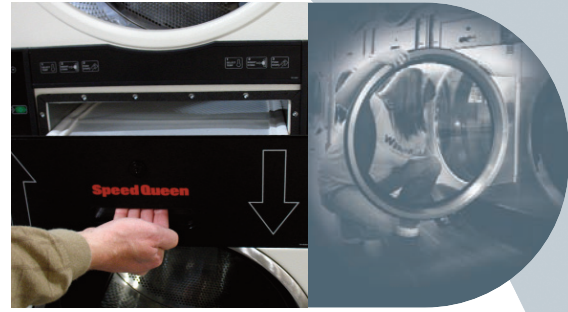

Excellent Capacity

At 60 and 90 lb, respectively, the stack 30 and 45 lb enable your laundry to offer substantial drying capacity in the space of a single pocket tumbler. In fact, replacing a 75 lb capacity dryer with a stack 45 lb may be a faster and more efficient drying option for pairing with a 60 lb washer-extractor.

Simple Installation

Speed Queen commercial stack dryers are easy to install with single gas, electrical and exhaust connections. This trims installation costs.

Fast Heating

Our high-performance burners ignite instantly, providing the desired temperature quickly and efficiently distributing even heat. This means reduced drying times and energy savings.

Less Lint Clean-Up

The stack's lint drawers offer maximum lint capacity in a minimum amount of space. This means staff isn't cleaning them out as often, while loads receive fast drying results.

Warranty

Speed Queen's commitment to customers comes with an industry-leading warranty, which starts with a three-year* limited parts warranty. To us, building the best machines on the market, doesn't mean much if we're not willing to also take the lead in standing behind them. As a Speed Queen customer, you'll never have to worry about our bond.

* Parts only, labor not included. See Speed Queen Warranty Bond for specifics.

OPL Stack Drying Tumblers Specifications

	STT30	STT45
Control Option	Dual Digital	Dual Digital
Dry Capacity - lb (kg)	2 @ 30 (13.6)	2 @ 45 (20.4)
Filling Ratio	20:1 = 33 (15.1)	20:1 = 46 (21.1)
Width - in (mm)	31 1/2" (800)	34 1/2" (876)
Depth - in (mm)	42 7/8" (1086)	48 5/8" (1235)
Height - in (mm)	76 1/4" (1937)	81 1/16" (2059)
Cylinder Diameter - in (mm)	30" (762)	33" (838)
Cylinder Depth - in (mm)	26" (660)	30" (762)
Cylinder Volume - cu. ft. (liters)	10.6 (301)	14.8 (421)
Door Opening Size - in (mm)	22 5/8" (576)	26 7/8" (683)
Airflow - cfm (liter/sec)	60 Hz: 400 (189) 50 Hz: 340 (160)	60 Hz: 600 (283) 50 Hz: 500 (236)
Air Outlet Diameter - in (mm)	1 x 8" (203)	1 x 10" (254)
Energy Data	Gas Models: 146,000 Btu/hr (42.8 kW) total Steam Models: At 100 psi (6.9 bar): 3.2 BHP, 111,000 Btu/hr (32.5 kW) At 15 psi (1.0 bar): 2.2 BHP, 74,000 Btu/hr (21.7 kW) Electric Models: 21 kW	Gas Models: 190,000 Btu/hr (55.6 kW) total - 60Hz 174,000 Btu/hr (51.0 kW) total - 50 Hz
Electrical Specifications	Gas and Steam Models: 120/208-240/60/1; 2W/3W+G 100/200-220/60/1; 2W+G 100/200/50/1; 2W+G 230-240/50/1; 2W+G 200-208/240/60/3; 3W+G 380/60/3; 3W+G 200/50/3; 3W+G 230-240/50/3; 3W+G 380/400-415/50/3; 3W+G 460-480/60/3; 3W+G Electric Models: 200-208/60/3; 3W+G 200/50/3; 3W+G 230-240/50/3; 3W+G * 240/60/3; 3W+G 380/60/3; 3W+G 380/50/3; 3W+G 400-415/50/3; 3W+G 460-480/60/3; 3W+G	Gas Models Only: 200/60/1; 2W+G 208-240/60/1; 3W+G 200-208/240/60/3; 3W+G 200/50/1; 2W+G 230-240/50/1; 2W+G
Motor Size - HP (W)	Fan Cylinder 1/4 (187) 1/4 (187)	1/2 (375) 1/2 (375)
Plumbing Connections	Gas Models: 1/2" - NPT One manifold gas connection. Steam Models: 3/4" - NPT	Gas Models: 1/2" - NPT One manifold gas connection.
Shipping Dimensions Approx. - in (mm)	Width Depth Height 32 1/2" (825) 47" (1194) 81" (2057)	35 1/2" (902) 54" (1372) 85" (2159)
Net Weight - lb (kg)	544 (247)	673 (305)
Shipping Weight - lb (kg)	582 (264)	718 (326)
Agency Approvals	Gas Models: CSA Star, CSA Flame, cCSA _{US} , CE, Australia Gas Electrical & Steam Models: cCSA _{US} , CE	Gas Models: CSA Star; CSA Flame, cCSA _{US} , CE, Australia Gas

*Not available in EU

Tumbler models are made to suit a variety of electrical service characteristics. See your Speed Queen distributor for specifications. For further details on installation, refer to Installation, Operation and Maintenance instructions supplied with the tumbler. Amperage ratings available in Installation Manual.

For the most accurate information, the installation guide should be used for all design and construction purposes. Due to continuous product improvements, design and specifications subject to change without notice. The quality management system of Alliance Laundry Systems' Ripon facility has been registered to ISO 9001:2000.

©Copyright 2009 Alliance Laundry Systems LLC